

Athens Center – Central Greece

# Commercial building of high visibility.

CODICE OGGETTO: GR23373109

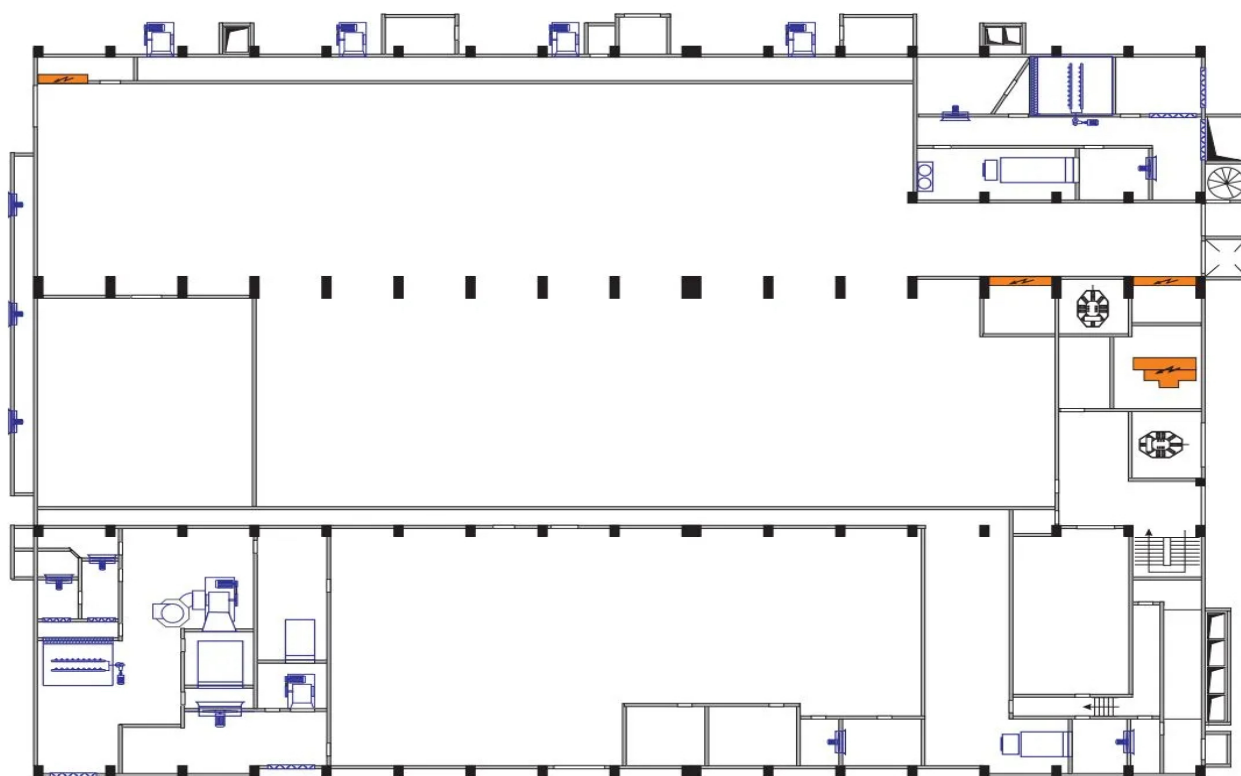

ΚΑΙΜΑ Ε: 1:200

PREZZO D'AFFITTO: 45.000 EUR

CODICE OGGETTO: GR23373109 - 122 42 Athens Center – Central Greece

- A colpo d'occhio
- La proprietà
- Una prima impressione
- Partner di contatto

CODICE OGGETTO: GR23373109 - 122 42 Athens Center – Central Greece

## A colpo d'occhio

CODICE OGGETTO	GR23373109	Ufficio/studio	Spazio ufficio
DISPONIBILE DAL	Previo accordo	Superficie commerciale	ca. 9.000 m <sup>2</sup>
Anno di costruzione	1973	Superficie lorda	ca. 0 m <sup>2</sup>

CODICE OGGETTO: GR23373109 - 122 42 Athens Center – Central Greece

## La proprietà

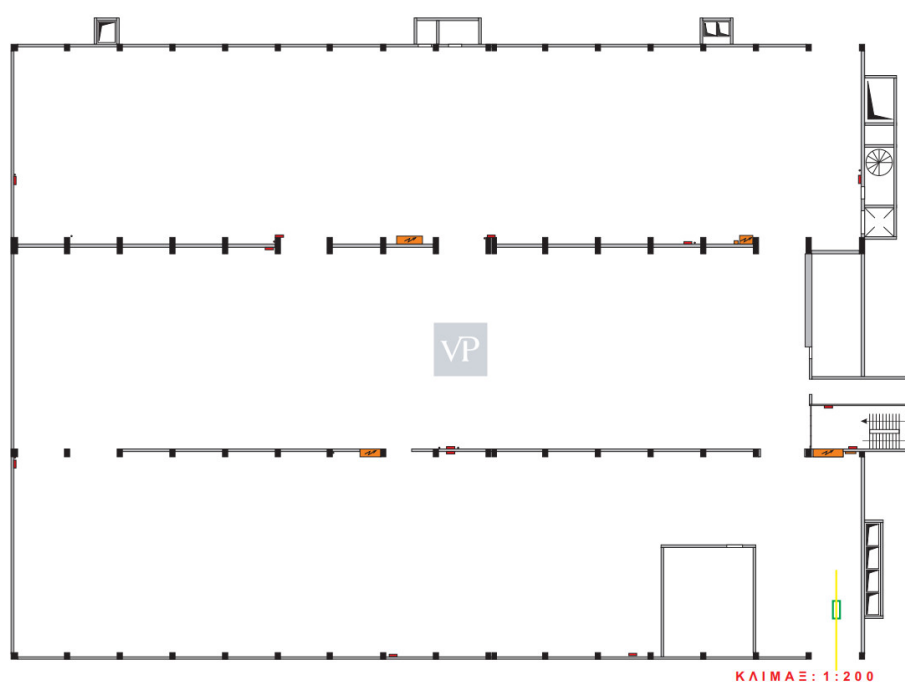
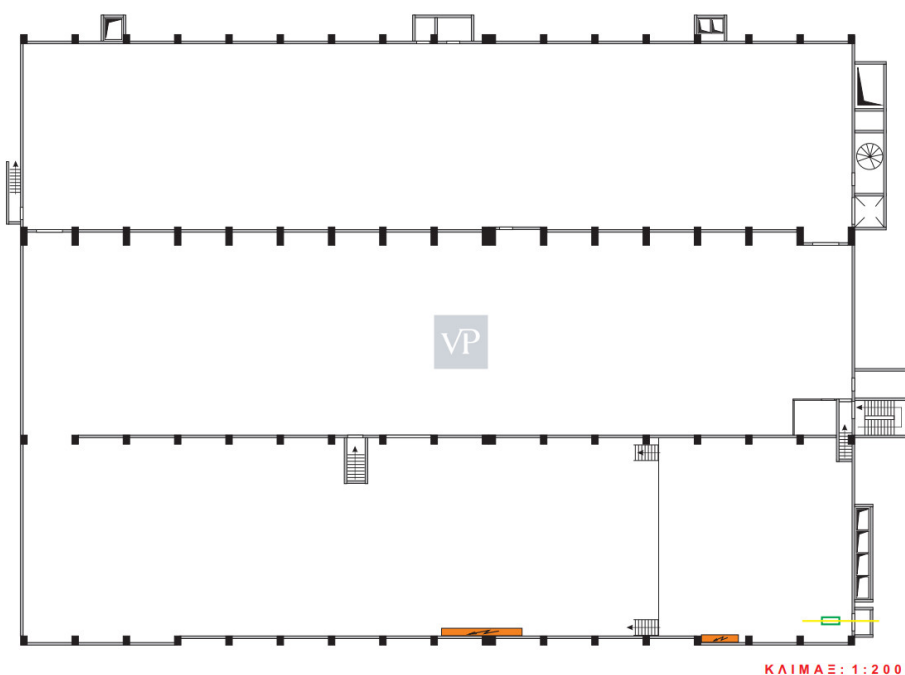

**CODICE OGGETTO: GR23373109 - 122 42 Athens Center – Central Greece**

## Una prima impressione

Commercial Building of high visibility. Surface 9000m<sup>2</sup> Plot surface 5000m<sup>2</sup> Levels 3 It consists of 3 levels of 3000sqm (ground floor with 2.65m net height - 1st floor with 5m height - 2nd floor with 3.2m height). It has a yard area of 1800 sqm. It is located within a complex of commercial buildings with controlled access. WC 6 Number of entrances 2 Parking spots 50 Loading dock It has an industrial elevator of 2 tons. It is suitable for any use.

CODICE OGGETTO: GR23373109 - 122 42 Athens Center – Central Greece

## Partner di contatto

Per ulteriori informazioni, si prega di contattare la persona di riferimento:

VON POLL REAL ESTATE Athens

---

Kifisias Avenue 227 Atene  
E-Mail: [salesgreece@von-poll.com](mailto:salesgreece@von-poll.com)

*To Disclaimer of von Poll Immobilien GmbH*

---

[www.von-poll.com](http://www.von-poll.com)