

Berlin / Friedrichshagen

Exclusive investment on the lake: rented 2-room luxury apartment with beautiful terrace & water access

Property ID: 24068023WE13



www.von-poll.com

PURCHASE PRICE: 830.000 EUR • LIVING SPACE: ca. 132 m² • ROOMS: 2

Property ID: 24068023WE13 - 12587 Berlin / Friedrichshagen

- At a glance
- The property
- Energy Data
- Floor plans
- A first impression
- Details of amenities
- All about the location
- Other information
- Contact partner

Property ID: 24068023WE13 - 12587 Berlin / Friedrichshagen

At a glance

Property ID	24068023WE13
Living Space	ca. 132 m ²
Floor	1
Rooms	2
Bedrooms	1
Bathrooms	2
Year of construction	1960

Purchase Price	830.000 EUR
Commission	Buyer's commission is 3.57 % (incl. VAT) of the notarized purchase price
Condition of property	Well-maintained
Construction method	Solid
Usable Space	ca. 7 m ²
Equipment	Terrace, Garden / shared use, Built-in kitchen

Property ID: 24068023WE13 - 12587 Berlin / Friedrichshagen

Energy Data

Type of heating	Underfloor heating	Energy Certificate	Energy demand certificate
Energy Source	Gas	Final Energy Demand	93.60 kWh/m ² a
Energy certificate valid until	29.07.2025	Energy efficiency class	C
Power Source	Gas	Year of construction according to energy certificate	2014

Property ID: 24068023WE13 - 12587 Berlin / Friedrichshagen

The property



Property ID: 24068023WE13 - 12587 Berlin / Friedrichshagen

The property



Property ID: 24068023WE13 - 12587 Berlin / Friedrichshagen

The property



Property ID: 24068023WE13 - 12587 Berlin / Friedrichshagen

The property



Property ID: 24068023WE13 - 12587 Berlin / Friedrichshagen

The property



Immobilie gefunden, *Finanzierung* gelöst.

Jetzt persönliches Kaufbudget berechnen und die passende Finanzierungslösung ermitteln.

www.von-poll.com/finanzieren



Finanzierung
berechnen



Property ID: 24068023WE13 - 12587 Berlin / Friedrichshagen

Floor plans

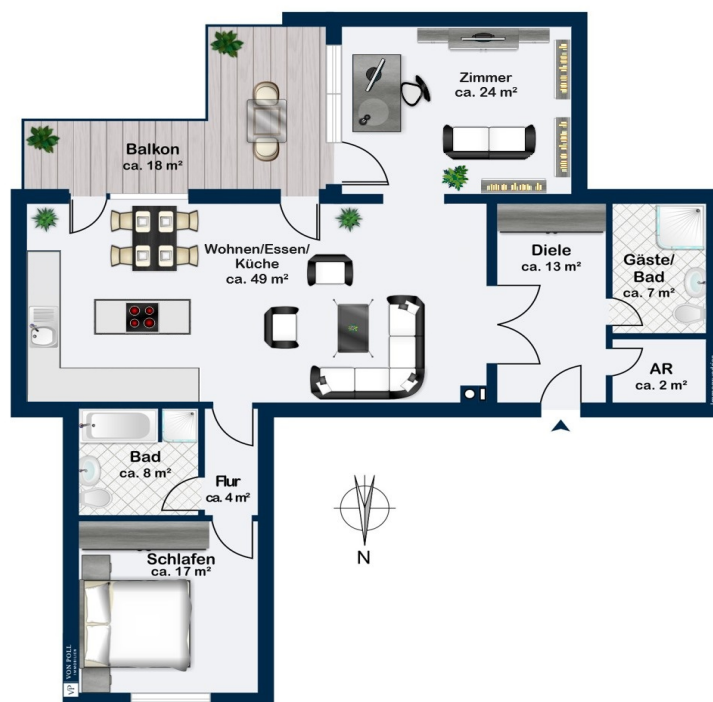

This floor plan is not to scale. The documents were given to us by the client. For this reason, we cannot guarantee the accuracy of the information.

Property ID: 24068023WE13 - 12587 Berlin / Friedrichshagen

A first impression

This exquisitely designed 2-room condominium is located in a dreamlike residential complex directly on the shores of the picturesque Müggelsee lake. With high-quality fixtures and fittings and an idyllic location, this property is a real gem. The staircase is already inviting, with natural stone floors and special light sources setting charming accents. A practical elevator takes you comfortably to the 1st floor and the entrance to this exclusive residential unit. Upon entering the approx. 123 m² apartment, the parquet flooring catches the eye, creating a warm and inviting ambience. The open and modern fitted kitchen is equipped with an induction hob to meet your culinary requirements. Here you can also enjoy your meal in the fresh air on the terrace in front, which offers a breathtaking view of Lake Müggelsee. The living room offers almost 50 m² of spaciousness and also has an exit to the terrace. The first spacious bathroom is equipped with a bathtub as well as a rain shower and there is another walk-in shower in the second bathroom. A cozy bedroom and a practical storage room round off this level. Should it get too warm in summer, air-conditioned ceilings ensure cooler temperatures and electric shutters and an awning protect against too much sunlight. Sophisticated lighting technology also makes it possible to set special lighting accents in all rooms. Thanks to the direct location on Müggelsee, you can enjoy nature to the full, whether it's water sports, walks along the lake or relaxing in the residential complex's own garden. The excellent connections to Berlin city center and the proximity to numerous shopping facilities and restaurants make this residential complex the perfect place to enjoy life. Located directly on the banks of the Müggelsee lake in the sought-after villa suburb of Friedrichshagen, this unique, spacious site covers a total area of around 11,000 m² in an exclusive waterside location. Consisting of several buildings, this apartment building was completed around 2021 and today comprises 23 top-class apartments. Facing south, the heart of the property is the approx. 115 m wide waterfront for exclusive impressions. A private beach invites you to bathe and swim here. This apartment is a bargain for investors! With a monthly basic rent of 2,850 euros, the yield is a whopping 4.1 percent. Don't miss out on this unique opportunity! Termination due to personal use is excluded here.

Property ID: 24068023WE13 - 12587 Berlin / Friedrichshagen

Details of amenities

- High-quality parquet flooring
- Porcelain stoneware tiles in the bathrooms
- 1st bathroom with walk-in shower with rain shower and bathtub
- 2nd bathroom with walk-in shower with rain shower
- Floor-to-ceiling wooden windows with triple insulated glazing
- Indirect lighting
- ceiling cooling
- electric roller shutters
- awning
- modern underfloor heating

Property ID: 24068023WE13 - 12587 Berlin / Friedrichshagen

All about the location

Geography: Friedrichshagen, a place of longing for stressed city dwellers, is an old villa suburb on the north-western shore of Lake Müggelsee. Founded by the famous Prussian King Frederick II in 1753, this district lies on the eastern edge of Berlin and is considered the most attractive residential area in Köpenick. The area is a magnet for discerning people and artists who are looking for peace and quiet, the proximity of woods and water, but still don't want to miss the connection to the big city. Friedrichshagen has a population of around 19,064 in 2021. Location / traffic: Friedrichshagen is well connected in terms of transportation with its S-Bahn station on Berlin line S 3 (Spandau - Erkner) and the B1/B5 as well as the Berlin freeway ring (A100) can be reached quickly. Alexanderplatz can be reached within 40 minutes via these routes. The proximity to Berlin's BER airport is also significant. The main street of the village is the popular Bölschestraße - it is ideal for strolling, shopping and dining in various restaurants and pubs. The surrounding villages in the direction of Rüdersdorf can be reached with the Schöneich streetcar (line 88). Line 60 takes you to Johannisthal and line 61 provides a connection between Friedrichshagen and Adlershof. Infrastructure: The infrastructure is very well developed, with a grammar school, schools, daycare centers, doctors, banks and plenty of shopping opportunities including organic markets, and there is also plenty of culture here. The popular shopping street Bölschestraße is a particular highlight and everyone's talking about it, with various stores, restaurants and cafés that invite you to take a stroll. A weekly market on the central market square also offers fresh products from the region. Economy: The Friedrichshagen waterworks is located on both sides of the Müggelsee dam. In addition to restaurants and cafés, there are numerous activities to satisfy the hunger for water sports of all kinds. Many sports clubs have their roots here and have a large number of members. Leisure / nature: Thanks to its direct location on the Großer Müggelsee lake, water sports enthusiasts can enjoy many opportunities for surfing, sailing, kiting and motor sports. A variety of art galleries and small and large painters hold openings and training sessions, and libraries organize language courses in the evenings. Friedrichshagen has always remained an artists' village alongside its many sportsmen and women.

Property ID: 24068023WE13 - 12587 Berlin / Friedrichshagen

Other information

Es liegt ein Energiebedarfsausweis vor. Dieser ist gültig bis 29.7.2025. Endenergiebedarf beträgt 93.60 kWh/(m²*a). Wesentlicher Energieträger der Heizung ist Gas. Das Baujahr des Objekts lt. Energieausweis ist 2014. Die Energieeffizienzklasse ist C. MONEY LAUNDERING: As a real estate brokerage company, von Poll Immobilien GmbH is obliged under § 2 para. 1 no. 14 and § 11 para. 1, 2 of the Money Laundering Act (GwG) to establish and verify the identity of the contractual partner when establishing a business relationship, or as soon as there is a serious interest in the execution of the real estate purchase contract. For this purpose, it is necessary for us to record the relevant data of your identity card (if you are acting as a natural person) in accordance with § 11 Para. 4 GwG - for example by means of a copy. In the case of a legal entity, we require a copy of the extract from the commercial register showing the beneficial owner. The Money Laundering Act stipulates that the broker must keep the copies or documents for five years. As our contractual partner, you also have a duty to cooperate in accordance with Section 11 (6) GwG. LIABILITY: We would like to point out that the property information, documents, plans etc. passed on by us originate from the seller or landlord. We therefore accept no liability for the accuracy or completeness of the information. It is therefore the responsibility of our customers to check the correctness of the property information and details contained therein. All real estate offers are non-binding and subject to errors, prior sale and rental or other interim utilization. OUR SERVICE FOR YOU AS THE OWNER: If you are planning to sell or let your property, it is important for you to know its market value. Have the current value of your property professionally assessed by one of our real estate specialists free of charge and without obligation. Our nationwide and international network enables us to bring sellers or landlords and interested parties together in the best possible way. All information in this exposé (property description, dimensions, prices, etc.) is based on information provided by the seller (or a third party). VON POLL IMMOBILIEN has only checked this information for plausibility and assumes no further liability for it. VON POLL IMMOBILIEN is liable for intent and gross negligence. In the event of simple negligence, VON POLL IMMOBILIEN shall only be liable for breaches of material rights and obligations arising from the content and purpose of the brokerage agreement.

Property ID: 24068023WE13 - 12587 Berlin / Friedrichshagen

Contact partner

For further information, please contact your contact person:

Ariane & Andreas Gräfenstein

Bölschestraße 106/107 Berlin - Treptow-Köpenick

E-Mail: treptow.koepenick@von-poll.com

To Disclaimer of von Poll Immobilien GmbH

www.von-poll.com