

Athens Center – Central Greece

# Commercial building of high visibility.

Property ID: GR23373109

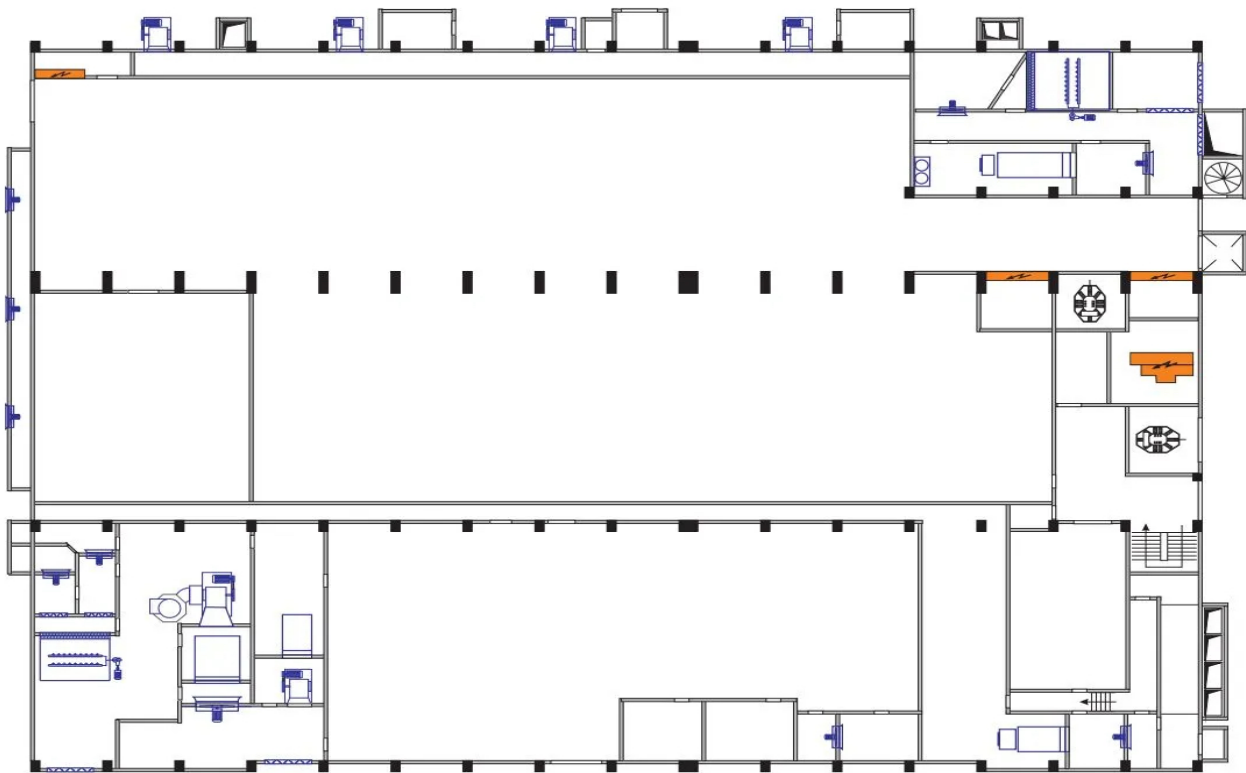

ΚΑΙΜΑ Ε: 1:200

RENT PRICE: 45.000 EUR

Property ID: GR23373109 - 122 42 Athens Center – Central Greece

- At a glance
- The property
- A first impression
- Contact partner

Property ID: GR23373109 - 122 42 Athens Center – Central Greece

## At a glance

Property ID	GR23373109	Total Space	ca. 9.000 m <sup>2</sup>
Available from	According to the arrangement	Usable Space	ca. 0 m <sup>2</sup>
Year of construction	1973		

Property ID: GR23373109 - 122 42 Athens Center – Central Greece

## The property

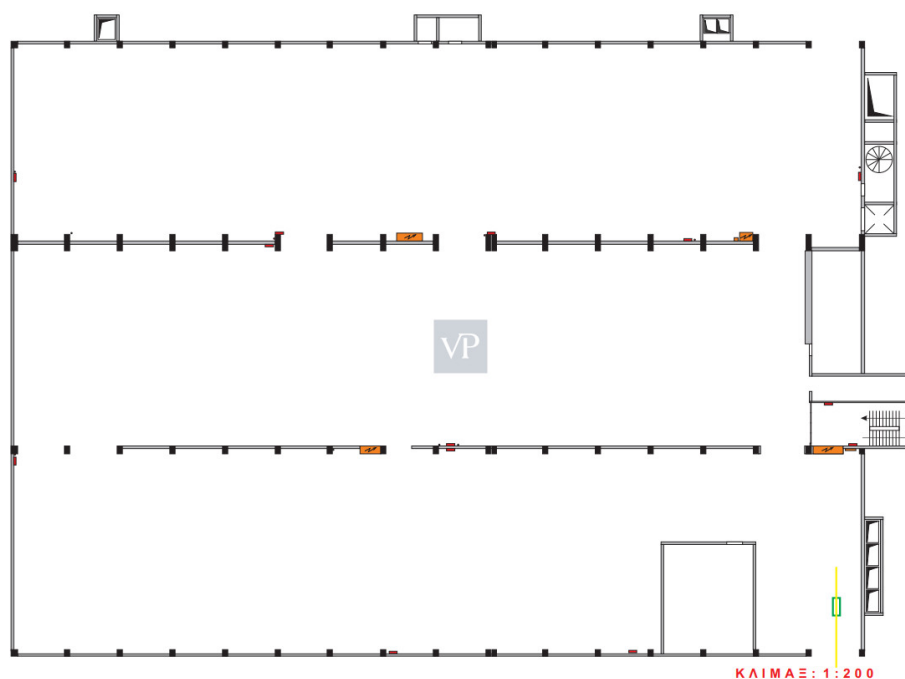
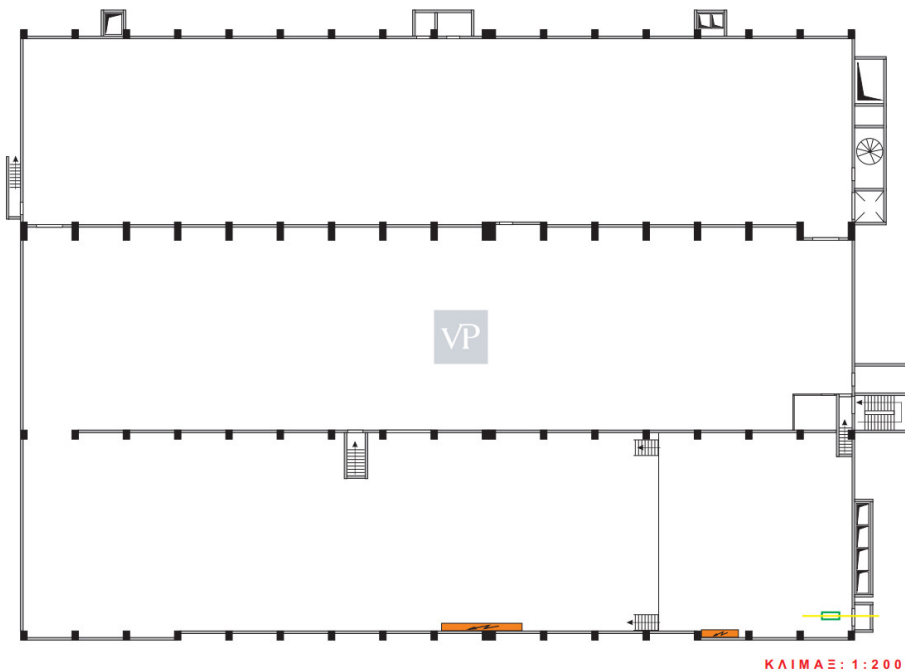

Property ID: GR23373109 - 122 42 Athens Center – Central Greece

## A first impression

Commercial Building of high visibility. Surface 9000m<sup>2</sup> Plot surface 5000m<sup>2</sup> Levels 3 It consists of 3 levels of 3000sqm (ground floor with 2.65m net height - 1st floor with 5m height - 2nd floor with 3.2m height). It has a yard area of 1800 sqm. It is located within a complex of commercial buildings with controlled access. WC 6 Number of entrances 2 Parking spots 50 Loading dock It has an industrial elevator of 2 tons. It is suitable for any use.

Property ID: GR23373109 - 122 42 Athens Center – Central Greece

## Contact partner

For further information, please contact your contact person:

VON POLL REAL ESTATE Athens

---

Kifisias Avenue 227 Athen  
E-Mail: [salesgreece@von-poll.com](mailto:salesgreece@von-poll.com)

*To Disclaimer of von Poll Immobilien GmbH*

---

[www.von-poll.com](http://www.von-poll.com)