

Esporles – Mitte

An exceptional villa with panoramic views in Esporles

Property ID: ES233744537



PURCHASE PRICE: 6.950.000 EUR • LIVING SPACE: ca. 212 m² • ROOMS: 6 • LAND AREA: 3.000 m²

Property ID: ES233744537 - 07190 Esporles – Mitte

- At a glance
- The property
- Energy Data
- A first impression
- All about the location
- Other information
- Contact partner

Property ID: ES233744537 - 07190 Esporles – Mitte

At a glance

Property ID	ES233744537	Purchase Price	6.950.000 EUR
Living Space	ca. 212 m ²	Condition of property	Well-maintained
Rooms	6	Usable Space	ca. 500 m ²
Bedrooms	5	Equipment	Terrace, Swimming pool, Sauna, Fireplace, Built-in kitchen
Bathrooms	5		
Type of parking	1 x Garage		

Property ID: ES233744537 - 07190 Esporles – Mitte

Energy Data

Type of heating	Central heating
Power Source	Oil
Energy information	At the time of preparing the document, no energy certificate was available.

Property ID: ES233744537 - 07190 Esporles – Mitte

The property



Property ID: ES233744537 - 07190 Esporles – Mitte

The property



Property ID: ES233744537 - 07190 Esporles – Mitte

The property



Property ID: ES233744537 - 07190 Esporles – Mitte

The property



Property ID: ES233744537 - 07190 Esporles – Mitte

The property



Property ID: ES233744537 - 07190 Esporles – Mitte

The property



Property ID: ES233744537 - 07190 Esporles – Mitte

The property

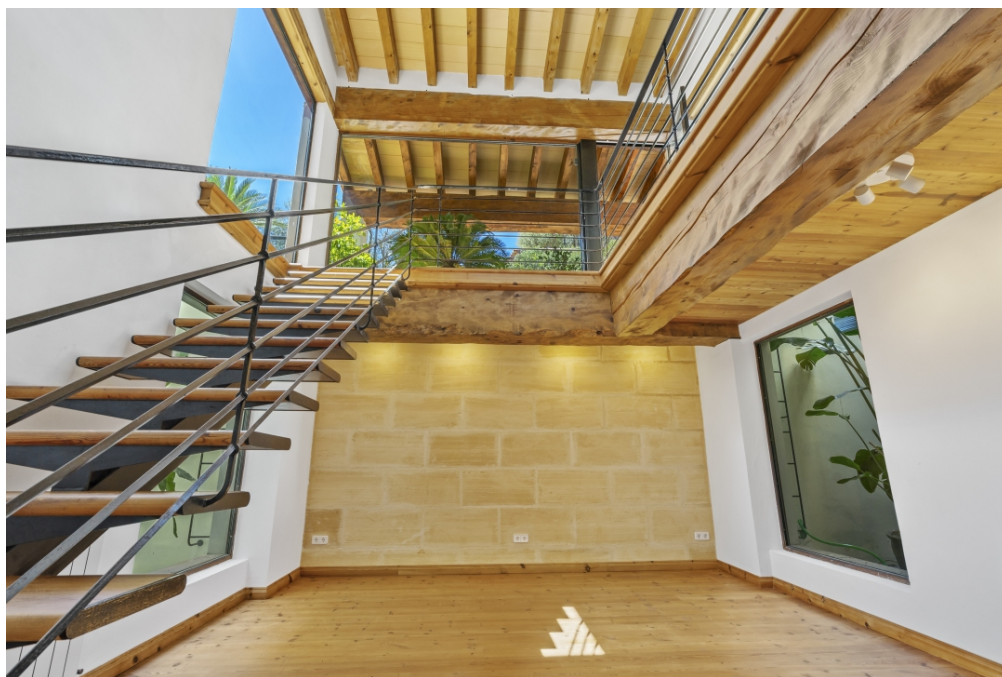

Property ID: ES233744537 - 07190 Esporles – Mitte

The property



Property ID: ES233744537 - 07190 Esporles – Mitte

The property



Property ID: ES233744537 - 07190 Esporles – Mitte

The property



Property ID: ES233744537 - 07190 Esporles – Mitte

The property



Property ID: ES233744537 - 07190 Esporles – Mitte

The property



Property ID: ES233744537 - 07190 Esporles – Mitte

The property



Property ID: ES233744537 - 07190 Esporles – Mitte

The property



Property ID: ES233744537 - 07190 Esporles – Mitte

The property



Property ID: ES233744537 - 07190 Esporles – Mitte

A first impression

The spacious first floor has a double living room with large windows spanning one side of the house, with stunning views of the valley. The kitchen is fully equipped with appliances and is also spacious and bright. From the living room there is access to a large terrace where you can enjoy the Mediterranean climate. On the upper floor there is an office area adjoining the living room, a guest bathroom and a spacious and bright bedroom. On the lower floor there are four further bedrooms, all of which are spacious and bright and have a large dressing room. In addition, there is a basement of approx. 250 m². The outdoor area is beautifully landscaped with pool. The villa is an architectural masterpiece that combines modern elegance with functionality and offers an exceptional home in a stunning location.

Property ID: ES233744537 - 07190 Esporles – Mitte

All about the location

Esporles is nestled in the foothills of the Serra de Tramuntana on Mallorca. This idyllic village combines tradition, nature and modernity. One of the attractions of Esporles is "La Granja", a historic manor house that serves as a museum. It offers fascinating insights into traditional Mallorcan life and includes beautiful gardens, workshops and an impressive collection of antiques. The parish church of San Pedro dominates the historic center of the village with its Gothic style and is a wonderful example of the region's religious architecture. For nature and sports lovers, Esporles is an ideal starting point for hiking and cycling tours in the Serra de Tramuntana, which offer breathtaking views and unspoiled nature. The location of Esporles is also extremely practical. It is only around 15 km northwest of Palma, the capital of Mallorca, and the airport is around 25 km away. There is a wide range of properties in Esporles, from traditional village houses to renovated fincas and luxurious country estates. The charming and tranquil surroundings make it a desirable place to live for those who want to experience the authentic Mallorca without sacrificing proximity to Palma.

Property ID: ES233744537 - 07190 Esporles – Mitte

Other information

We generally recommend having the building law situation checked by a specialist lawyer. All details are based exclusively on information provided by the owner or client. We assume no liability for the completeness, accuracy and timeliness of the information. The brokerage fee is payable by the vendor. Any taxes, notary and land registry costs incurred on the purchase are to be borne by the buyer.

Property ID: ES233744537 - 07190 Esporles – Mitte

Contact partner

For further information, please contact your contact person:

Florian Waetzoldt

Placa Hostals 11 Mallorca – Santa Maria

E-Mail: santamaria@von-poll.com

To Disclaimer of von Poll Immobilien GmbH

www.von-poll.com