

Colonia de Sant Jordi – Süd

# Modern new-build penthouse apartment with sea views, roof terrace and communal pool in Colonia de Sant Jordi

Property ID: ES24379084



PURCHASE PRICE: 970.000 EUR • LIVING SPACE: ca. 151 m<sup>2</sup> • ROOMS: 4

Property ID: ES24379084 - 07638 Colonia de Sant Jordi – Süd

- At a glance
- The property
- Energy Data
- Floor plans
- A first impression
- Details of amenities
- All about the location
- Contact partner

Property ID: ES24379084 - 07638 Colonia de Sant Jordi – Süd

## At a glance

Property ID	ES24379084	Purchase Price	970.000 EUR
Living Space	ca. 151 m <sup>2</sup>	Condition of property	First occupancy
Rooms	4	Construction method	Solid
Bedrooms	3	Equipment	Terrace, Swimming pool, Garden / shared use, Built-in kitchen
Bathrooms	3		
Year of construction	2026		
Type of parking	1 x Underground car park		

Property ID: ES24379084 - 07638 Colonia de Sant Jordi – Süd

## Energy Data

Type of heating	Underfloor heating
Power Source	Electric
Energy information	At the time of preparing the document, no energy certificate was available.

Property ID: ES24379084 - 07638 Colonia de Sant Jordi – Süd

## The property



Property ID: ES24379084 - 07638 Colonia de Sant Jordi – Süd

## The property



Property ID: ES24379084 - 07638 Colonia de Sant Jordi – Süd

## The property



Property ID: ES24379084 - 07638 Colonia de Sant Jordi – Süd

## The property





Property ID: ES24379084 - 07638 Colonia de Sant Jordi – Süd

## The property



Property ID: ES24379084 - 07638 Colonia de Sant Jordi – Süd

# Floor plans

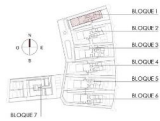

Nº	DESCRIPCIÓN UTILIDAD / FLOOR AREA / NUTZFLÄCHE	TIPO / TYPE	C2
1	VESTIBULO / HALL / VESTIBUL	1,81 m2	
2	PASO / CORRIDOR / DURCHGANG	6,48 m2	
8	COCINA / KITCHEN / KÜCHE	9,29 m2	
7	SALA / SALA / GALLERY / WITZENSCHAFTSRaum	6,42 m2	
8	SALON COMEDOR / LIVING-DINING ROOM / WOHNESSIMMER	36,84 m2	
9	DORMITORIO 1 / BEDROOM 1 / SCHLAFZIMMER 1	14,29 m2	
10	DORMITORIO 2 / BEDROOM 2 / SCHLAFZIMMER 2	12,17 m2	
11	DORMITORIO 3 / BEDROOM 3 / SCHLAFZIMMER 3	11,95 m2	
12	BANO 1 / BATHROOM 1 / BADZIMMER 1	6,17 m2	
13	BANO 2 / BATHROOM 2 / BADZIMMER 2	5,98 m2	
14	TRASTERO / STOREROOM / ABSTELLRAUM	2,38 m2	
15	ESCALERAS / STAIRS / TREPPEN	5,98 m2	
30	ASEO / WC / WC	2,05 m2	
<b>TOTAL SUP. UTILIDAD / TOTAL FLOOR AREA / GESAMTE NUTZFLÄCHE</b>			
<b>122,91 m2</b>			
<b>SUP. CONTRUCCION INTERIOR / BUILT INTERIOR AREA / BEBAUTE INNENFLÄCHE</b>			
<b>101,14 m2</b>			
<b>SUP. CONTRUCCION SOLARIUM / BUILT SOLARIUM AREA / BEBAUTE SOLARIUMFLÄCHE</b>			
<b>147,23 m2</b>			
<b>SUP. CONTRUCCION DE TERRAZA DESCUBIERTA / BUILT OPEN TERRACE / AREA / BEBAUTE TERRASSE</b>			
<b>61,48 m2</b>			
<b>SUP. CONTRUCCION DE TERRAZA DESCUBIERTA 2 / BUILT OPEN TERRACE 2 / AREA / BEBAUTE TERRASSE 2</b>			
<b>14,23 m2</b>			
<b>SUP. CONTRUCCION DE TERRAZA DESCUBIERTA 3 / BUILT OPEN TERRACE 3 / AREA / BEBAUTE TERRASSE 3</b>			
<b>8,32 m2</b>			
<b>TOTAL SUP. CONTRUCCION PRIVADA / TOTAL BUILT PRIVATE AREA / GESAMTE BEBAUTE FLÄCHE</b>			
<b>336,38 m2</b>			



PLANTA SOLARIUM



PLANTA SEGUNDA

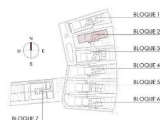

Nº	DESCRIPCIÓN UTILIDAD / FLOOR AREA / NUTZFLÄCHE	TIPO / TYPE	F2
1	VESTIBULO / HALL / VESTIBUL	2,42 m2	
2	PASO / CORRIDOR / DURCHGANG	19,71 m2	
8	COCINA / KITCHEN / KÜCHE	9,49 m2	
7	SALA / SALA / GALLERY / WITZENSCHAFTSRaum	4,08 m2	
8	SALON COMEDOR / LIVING-DINING ROOM / WOHNESSIMMER	35,20 m2	
9	DORMITORIO 1 / BEDROOM 1 / SCHLAFZIMMER 1	12,16 m2	
10	DORMITORIO 2 / BEDROOM 2 / SCHLAFZIMMER 2	12,40 m2	
11	DORMITORIO 3 / BEDROOM 3 / SCHLAFZIMMER 3	12,97 m2	
12	BANO 1 / BATHROOM 1 / BADZIMMER 1	5,98 m2	
13	BANO 2 / BATHROOM 2 / BADZIMMER 2	5,98 m2	
14	TRASTERO / STOREROOM / ABSTELLRAUM	2,38 m2	
15	ESCALERAS / STAIRS / TREPPEN	5,98 m2	
30	ASEO / WC / WC	2,05 m2	
<b>TOTAL SUP. UTILIDAD / TOTAL FLOOR AREA / GESAMTE NUTZFLÄCHE</b>			
<b>128,11 m2</b>			
<b>SUP. CONTRUCCION INTERIOR / BUILT INTERIOR AREA / BEBAUTE INNENFLÄCHE</b>			
<b>107,75 m2</b>			
<b>SUP. CONTRUCCION SOLARIUM / BUILT SOLARIUM AREA / BEBAUTE SOLARIUMFLÄCHE</b>			
<b>32,28 m2</b>			
<b>SUP. CONTRUCCION DE TERRAZA DESCUBIERTA / BUILT OPEN TERRACE / AREA / BEBAUTE TERRASSE</b>			
<b>28,71 m2</b>			
<b>SUP. CONTRUCCION DE TERRAZA DESCUBIERTA 2 / BUILT OPEN TERRACE 2 / AREA / BEBAUTE TERRASSE 2</b>			
<b>3,28 m2</b>			
<b>TOTAL SUP. CONTRUCCION PRIVADA / TOTAL BUILT PRIVATE AREA / GESAMTE BEBAUTE FLÄCHE</b>			
<b>182,24 m2</b>			



PLANTA SOLARIUM



This floor plan is not to scale. The documents were given to us by the client. For this reason, we cannot guarantee the accuracy of the information.

Property ID: ES24379084 - 07638 Colonia de Sant Jordi – Süd

## A first impression

Discover this unique new-build penthouse apartment in a stylish residential complex with 28 units, which impresses with its architecture in elegant shades of white and brown. In the picturesque Colonia de Sant Jordi, just 100 meters from the Mediterranean Sea, the apartments offer a pure Mediterranean lifestyle. The light-flooded units have a generous living space of 151 square meters with three bedrooms and three bathrooms, one of which is en suite. Enjoy relaxing hours on the balcony and on the private roof terrace, which offers spectacular views of the sea. The complex includes a communal garden with a large pool and a relaxing jacuzzi - perfect for relaxing days under the sun. On request, the apartments can be sold fully furnished for an extra charge. The apartment can be sold fully furnished for an additional cost. The apartments also include a cellar room and an underground parking space. Completion is planned for November 2026.

Property ID: ES24379084 - 07638 Colonia de Sant Jordi – Süd

## Details of amenities

- Underfloor heating (electric)
- Air heat pump for hot water
- Air conditioning hot/cold
- Double glazed windows
- Motorized blinds
- Fitted kitchen with island
- Extractor hood
- LED strips under the wall units (kitchen)
- Lighting with recessed LED spotlights in the bathroom
- Shower screen with safety glass
- High-quality built-in shower fitting
- Balcony
- Roof terrace
- Communal garden
- Swimming pool 80m<sup>2</sup>
- Heated whirlpool
- Cellar room
- Parking lot
- Pre-installation for electric vehicle charging station at all parking spaces in the underground garage
- Municipal water supply
- Municipal power supply

Property ID: ES24379084 - 07638 Colonia de Sant Jordi – Süd

## All about the location

Colonia de Sant Jordi is a charming coastal village in the southeast of Mallorca. Known for its picturesque beaches and crystal clear waters, this place offers an ideal mix of relaxation and activity. The main street is lined with inviting restaurants, cafés and stores selling local delicacies and handicrafts. The port of Colonia de Sant Jordi is a popular starting point for boat trips to the surrounding islands, including the enchanting Cabrera Islands. The beaches, such as Playa Es Trenc, are famous for their fine, white sand and turquoise waters, which are perfect for swimming and sunbathing. For nature lovers, there are numerous hiking and cycling trails in the area that lead through a beautiful landscape.

Property ID: ES24379084 - 07638 Colonia de Sant Jordi – Süd

## Contact partner

For further information, please contact your contact person:

Philip Bornewasser

---

Ronda Migjorn, 145B Mallorca – Lluçmajor

E-Mail: [llucmajor@von-poll.com](mailto:llucmajor@von-poll.com)

*To Disclaimer of von Poll Immobilien GmbH*

---

[www.von-poll.com](http://www.von-poll.com)