

Colonia de Sant Jordi – Süd

Modern new-build penthouse apartment with sea views, roof terrace and communal pool in Colonia de Sant Jordi

Property ID: ES24379084



PURCHASE PRICE: 970.000 EUR • LIVING SPACE: ca. 151 m² • ROOMS: 4

Property ID: ES24379084 - 07638 Colonia de Sant Jordi – Süd

- At a glance
- The property
- Energy Data
- Floor plans
- A first impression
- Details of amenities
- All about the location
- Contact partner

Property ID: ES24379084 - 07638 Colonia de Sant Jordi – Süd

At a glance

Property ID	ES24379084
Living Space	ca. 151 m²
Rooms	4
Bedrooms	3
Bathrooms	3
Year of construction	2026
Type of parking	1 x Underground car park

Purchase Price	970.000 EUR
Condition of property	First occupancy
Construction method	Solid
Equipment	Terrace, Swimming pool, Garden / shared use, Built-in kitchen

Property ID: ES24379084 - 07638 Colonia de Sant Jordi – Süd

Energy Data

Type of heating	Underfloor heating
Power Source	Electric
Energy information	At the time of preparing the document, no energy certificate was available.

Property ID: ES24379084 - 07638 Colonia de Sant Jordi – Süd

The property



Property ID: ES24379084 - 07638 Colonia de Sant Jordi – Süd

The property



Property ID: ES24379084 - 07638 Colonia de Sant Jordi – Süd

The property



Property ID: ES24379084 - 07638 Colonia de Sant Jordi – Süd

The property



Property ID: ES24379084 - 07638 Colonia de Sant Jordi – Süd

The property



Property ID: ES24379084 - 07638 Colonia de Sant Jordi – Süd

Floor plans

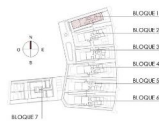

Nº	SUPERFICIES ÚTILES / FLOOR AREA / NUTZFLÄCHE	TIPO / TYPE	C2
1	VESTIBULO / HALL / VESTIBÜLE	1,51 m²	
2	PASO / CORRIDOR / DURCHGANG	6,46 m²	
3	COCINA / KITCHEN / KÜCHE	9,20 m²	
7	SALA / SALA / GALLERY / FREIZEITRAUM	6,80 m²	
8	SALON COMEDOR / LIVING DINING ROOM / WOHN-ESSENZIMMER	30,88 m²	
9	DORMITORIO 1 / BEDROOM 1 / SCHLAFZIMMER 1	14,28 m²	
10	DORMITORIO 2 / BEDROOM 2 / SCHLAFZIMMER 2	12,17 m²	
11	DORMITORIO 3 / BEDROOM 3 / SCHLAFZIMMER 3	11,98 m²	
12	BANO 1 / BATHROOM 1 / BADZIMMER 1	6,17 m²	
13	BANO 2 / BATHROOM 2 / BADZIMMER 2	5,98 m²	
14	TRASTERO / STORE ROOM / ABSTELLRAUM	2,38 m²	
15	ESCALERAS / STAIRS / TREPPEN	5,96 m²	
30	ÁREAS / AREAS / AREAS	2,95 m²	
TOTAL SUP. ÚTILES / TOTAL FLOOR AREA / GESAMTE NUTZFLÄCHE		122,01 m²	
SUP. CONTRUÍDA INTERIOR / BUILT INTERIOR AREA / BESAUTE INNENFLÄCHE		101,14 m²	
SUP. CONTRUÍDA SOLARIM / BUILT SOLARIM AREA / BESAUTE SOLARIMFLÄCHE		147,33 m²	
SUP. CONTRUÍDA DE TERRAZA DESCUBIERTA 1 / BUILT OPEN TERRACE 1 AREA / BESAUTE TERRAZA 1		61,48 m²	
SUP. CONTRUÍDA DE TERRAZA DESCUBIERTA 2 / BUILT OPEN TERRACE 2 AREA / BESAUTE TERRAZA 2		14,28 m²	
SUP. CONTRUÍDA DE TERRAZA DESCUBIERTA 3 / BUILT OPEN TERRACE 3 AREA / BESAUTE TERRAZA 3		5,10 m²	
TOTAL SUP. CONTRUÍDA PRIVADA / TOTAL BUILT PRIVATE AREA / GESAMTE BESAUTE FLÄCHE		176,24 m²	



PLANTA SOLARIUM



PLANTA SEGUNDA

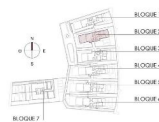

Nº	SUPERFICIES ÚTILES / FLOOR AREA / NUTZFLÄCHE	TIPO / TYPE	P2
1	VESTIBULO / HALL / VESTIBÜLE	8,82 m²	
2	PASO / CORRIDOR / DURCHGANG	19,72 m²	
3	COCINA / KITCHEN / KÜCHE	9,60 m²	
7	SALA / SALA / GALLERY / FREIZEITRAUM	6,08 m²	
8	SALON COMEDOR / LIVING DINING ROOM / WOHN-ESSENZIMMER	31,50 m²	
9	DORMITORIO 1 / BEDROOM 1 / SCHLAFZIMMER 1	17,16 m²	
10	DORMITORIO 2 / BEDROOM 2 / SCHLAFZIMMER 2	14,90 m²	
11	DORMITORIO 3 / BEDROOM 3 / SCHLAFZIMMER 3	12,97 m²	
12	BANO 1 / BATHROOM 1 / BADZIMMER 1	5,98 m²	
13	BANO 2 / BATHROOM 2 / BADZIMMER 2	5,98 m²	
14	TRASTERO / STORE ROOM / ABSTELLRAUM	2,38 m²	
15	ESCALERAS / STAIRS / TREPPEN	5,30 m²	
30	ÁREAS / AREAS / AREAS	2,95 m²	
TOTAL SUP. ÚTILES / TOTAL FLOOR AREA / GESAMTE NUTZFLÄCHE		128,10 m²	
SUP. CONTRUÍDA INTERIOR / BUILT INTERIOR AREA / BESAUTE INNENFLÄCHE		108,11 m²	
SUP. CONTRUÍDA SOLARIM / BUILT SOLARIM AREA / BESAUTE SOLARIMFLÄCHE		147,75 m²	
SUP. CONTRUÍDA DE TERRAZA DESCUBIERTA 1 / BUILT OPEN TERRACE 1 AREA / BESAUTE TERRAZA 1		52,28 m²	
SUP. CONTRUÍDA DE TERRAZA DESCUBIERTA 2 / BUILT OPEN TERRACE 2 AREA / BESAUTE TERRAZA 2		28,71 m²	
SUP. CONTRUÍDA DE TERRAZA DESCUBIERTA 3 / BUILT OPEN TERRACE 3 AREA / BESAUTE TERRAZA 3		5,38 m²	
TOTAL SUP. CONTRUÍDA PRIVADA / TOTAL BUILT PRIVATE AREA / GESAMTE BESAUTE FLÄCHE		194,14 m²	



PLANTA SOLARIUM



This floor plan is not to scale. The documents were given to us by the client. For this reason, we cannot guarantee the accuracy of the information.

Property ID: ES24379084 - 07638 Colonia de Sant Jordi – Süd

A first impression

Discover this unique new-build penthouse apartment in a stylish residential complex with 28 units, which impresses with its architecture in elegant shades of white and brown. In the picturesque Colonia de Sant Jordi, just 100 meters from the Mediterranean Sea, the apartments offer a pure Mediterranean lifestyle. The light-flooded units have a generous living space of 151 square meters with three bedrooms and three bathrooms, one of which is en suite. Enjoy relaxing hours on the balcony and on the private roof terrace, which offers spectacular views of the sea. The complex includes a communal garden with a large pool and a relaxing jacuzzi - perfect for relaxing days under the sun. On request, the apartments can be sold fully furnished for an extra charge. The apartment can be sold fully furnished for an additional cost. The apartments also include a cellar room and an underground parking space. Completion is planned for November 2026.

Property ID: ES24379084 - 07638 Colonia de Sant Jordi – Süd

Details of amenities

- Underfloor heating (electric)
- Air heat pump for hot water
- Air conditioning hot/cold
- Double glazed windows
- Motorized blinds
- Fitted kitchen with island
- Extractor hood
- LED strips under the wall units (kitchen)
- Lighting with recessed LED spotlights in the bathroom
- Shower screen with safety glass
- High-quality built-in shower fitting
- Balcony
- Roof terrace
- Communal garden
- Swimming pool 80m²
- Heated whirlpool
- Cellar room
- Parking lot
- Pre-installation for electric vehicle charging station at all parking spaces in the underground garage
- Municipal water supply
- Municipal power supply

Property ID: ES24379084 - 07638 Colonia de Sant Jordi – Süd

All about the location

Colonia de Sant Jordi is a charming coastal village in the southeast of Mallorca. Known for its picturesque beaches and crystal clear waters, this place offers an ideal mix of relaxation and activity. The main street is lined with inviting restaurants, cafés and stores selling local delicacies and handicrafts. The port of Colonia de Sant Jordi is a popular starting point for boat trips to the surrounding islands, including the enchanting Cabrera Islands. The beaches, such as Playa Es Trenc, are famous for their fine, white sand and turquoise waters, which are perfect for swimming and sunbathing. For nature lovers, there are numerous hiking and cycling trails in the area that lead through a beautiful landscape.

Property ID: ES24379084 - 07638 Colonia de Sant Jordi – Süd

Contact partner

For further information, please contact your contact person:

Philip Bornewasser

Ronda Migjorn, 145B Mallorca – Llucmajor

E-Mail: llucmajor@von-poll.com

To Disclaimer of von Poll Immobilien GmbH

www.von-poll.com