

Luxembourg-Centre ville – CBD

## Fully renovated office located on the 3rd floor

*Property ID: 39*



Property ID: 39 - L-1470 Luxembourg-Centre ville – CBD

- At a glance
- The property
- Energy Data
- Floor plans
- A first impression
- All about the location
- Contact partner

Property ID: 39 - L-1470 Luxembourg-Centre ville – CBD

## At a glance

Property ID	39	Rent price	On request
Floor	3	Commission	Fees charged to the owner
Type of parking	3 x Garage	Total Space	ca. 433 m <sup>2</sup>

Property ID: 39 - L-1470 Luxembourg-Centre ville – CBD

## Energy Data

Type of heating	Central heating
Energy information	At the time of preparing the document, no energy certificate was available.

Property ID: 39 - L-1470 Luxembourg-Centre ville – CBD

## The property



Property ID: 39 - L-1470 Luxembourg-Centre ville – CBD

## The property





Property ID: 39 - L-1470 Luxembourg-Centre ville – CBD

## The property



Property ID: 39 - L-1470 Luxembourg-Centre ville – CBD

## The property





Property ID: 39 - L-1470 Luxembourg-Centre ville – CBD

## Floor plans

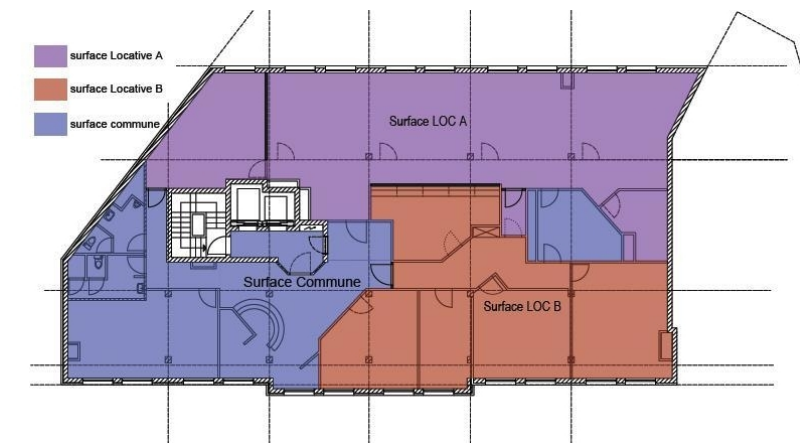

This floor plan is not to scale. The documents were given to us by the client. For this reason, we cannot guarantee the accuracy of the information.

Property ID: 39 - L-1470 Luxembourg-Centre ville – CBD

## A first impression

Office space completely renovated and crossing located on the 3rd floor of a beautiful building .. The property is very bright and easy to arrange. It consists of an entrance, two open-spaces, balconies overlooking the front, IT room, sanitary and kitchen with space consumption. The offices are fully wired. There are 4 parking spaces. The space is close to all amenities and easy to access. It is close to motorways, P + R and bus lines.

Property ID: 39 - L-1470 Luxembourg-Centre ville – CBD

## All about the location

Luxembourg-Centre Ville

Property ID: 39 - L-1470 Luxembourg-Centre ville – CBD

## Contact partner

For further information, please contact your contact person:

VON POLL REAL ESTATE Limpertsberg

---

6, avenue Pasteur Limpertsberg  
E-Mail: [limpertsberg@von-poll.com](mailto:limpertsberg@von-poll.com)

*To Disclaimer of von Poll Immobilien GmbH*

---

[www.von-poll.com](http://www.von-poll.com)