

Leudelange – Lux périphérie Ouest

Office space for rent

Property ID: LU881800069



Property ID: LU881800069 - L-3364 Leudelange – Lux périphérie Ouest

- At a glance
- The property
- Floor plans
- A first impression
- Contact partner

Property ID: LU881800069 - L-3364 Leudelange – Lux périphérie Ouest

At a glance

Property ID	LU881800069	Rent price	On request
Available from	29.04.2019	Commission	Fees paid by the owner
Type of parking	3 x Outdoor parking space, 115 EUR (Rent), 37 x Underground car park, 161 EUR (Rent)	Total Space	ca. 1.372 m ²

Property ID: LU881800069 - L-3364 Leudelange – Lux périphérie Ouest

The property



Property ID: LU881800069 - L-3364 Leudelange – Lux périphérie Ouest

The property



Property ID: LU881800069 - L-3364 Leudelange – Lux périphérie Ouest

The property



Property ID: LU881800069 - L-3364 Leudelange – Lux périphérie Ouest

The property



Property ID: LU881800069 - L-3364 Leudelange – Lux périphérie Ouest

The property



Property ID: LU881800069 - L-3364 Leudelange – Lux périphérie Ouest

The property



Property ID: LU881800069 - L-3364 Leudelange – Lux périphérie Ouest

The property



Property ID: LU881800069 - L-3364 Leudelange – Lux périphérie Ouest

Floor plans

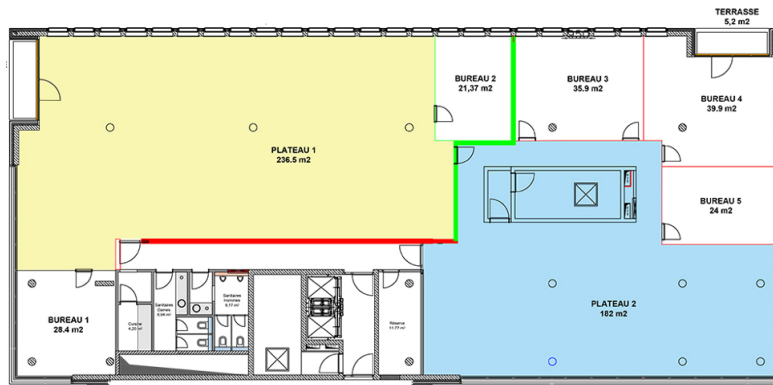

7

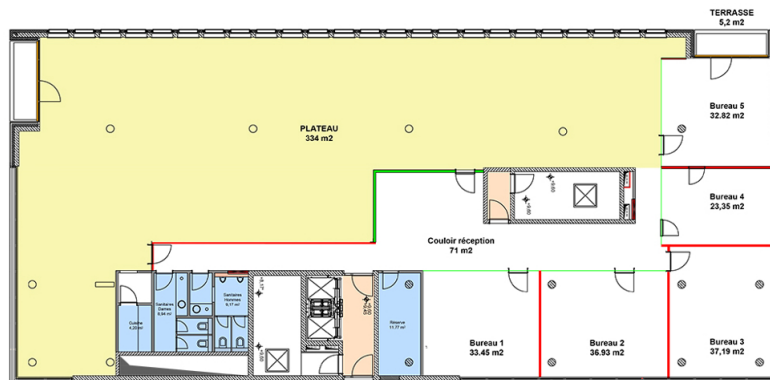

This floor plan is not to scale. The documents were given to us by the client. For this reason, we cannot guarantee the accuracy of the information.

Property ID: LU881800069 - L-3364 Leudelange – Lux périphérie Ouest

A first impression

Recent office building with good visibility. They consist of 2 fully equipped trays of 686 m² each, on the 2nd and 3rd floor of the building. The surfaces are composed of open space, partitioned offices, toilets, kitchenette, IT room. Close to all amenities. Highway axes nearby.

Property ID: LU881800069 - L-3364 Leudelange – Lux périphérie Ouest

Contact partner

For further information, please contact your contact person:

VON POLL REAL ESTATE Limpertsberg

6, avenue Pasteur Limpertsberg
E-Mail: limpertsberg@von-poll.com

To Disclaimer of von Poll Immobilien GmbH

www.von-poll.com