

Athens Center – Central Greece

Commercial building of high visibility.

Objektnummer: GR23373109

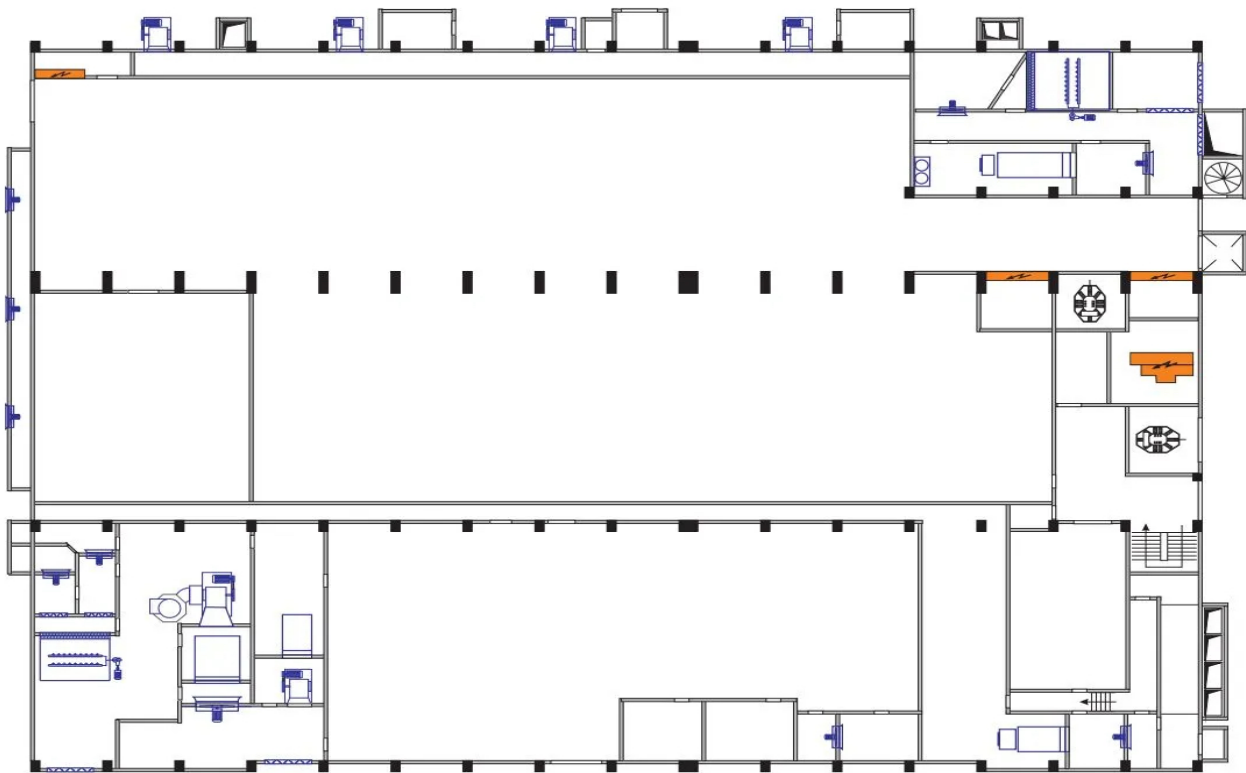

ΚΑΙΜΑ Ε : 1 : 200

MIETPREIS: 45.000 EUR

Objektnummer: GR23373109 - 122 42 Athens Center – Central Greece

- Auf einen Blick
- Die Immobilie
- Ein erster Eindruck
- Ansprechpartner

Objektnummer: GR23373109 - 122 42 Athens Center – Central Greece

Auf einen Blick

| | | | |
|---------------|-------------------|--------------|--------------------------|
| Objektnummer | GR23373109 | Büro/Praxen | Bürofläche |
| Bezugsfrei ab | nach Vereinbarung | Gesamtfläche | ca. 9.000 m ² |
| Baujahr | 1973 | Nutzfläche | ca. 0 m ² |

Objektnummer: GR23373109 - 122 42 Athens Center – Central Greece

Die Immobilie

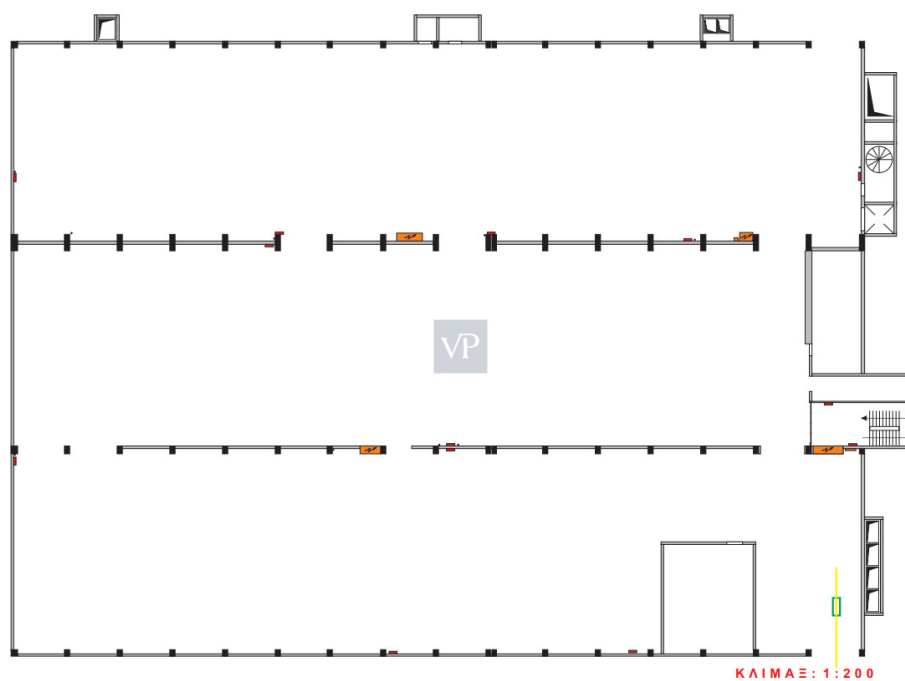
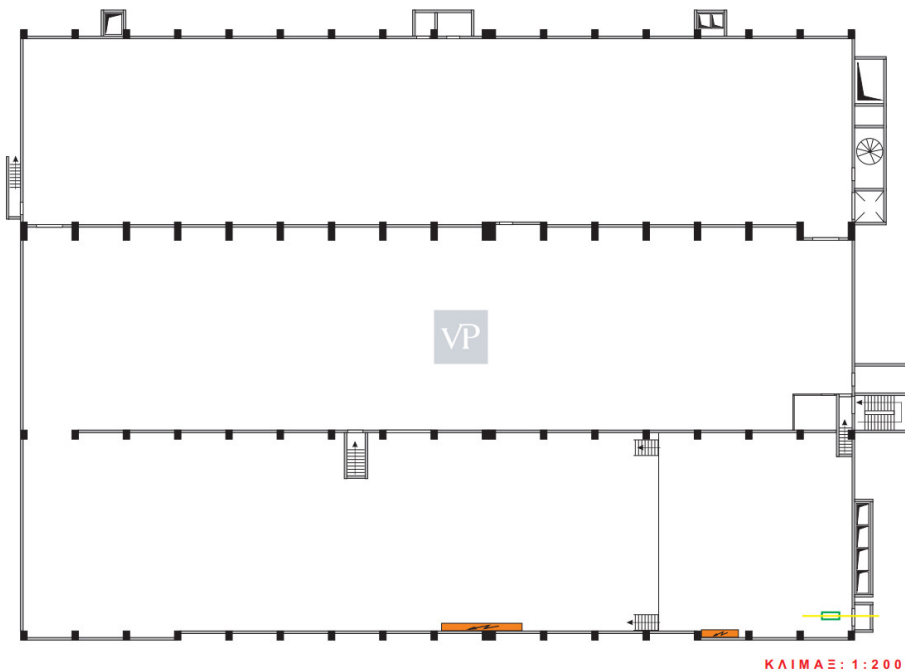

Objektnummer: GR23373109 - 122 42 Athens Center – Central Greece

Ein erster Eindruck

Commercial building of high visibility. It consists of 3 levels of 3000sqm (ground floor with 2.65m net height - 1st floor with 5m height - 2nd floor with 3.2m height). It has a yard area of 1800sqm. It is located within a complex of commercial buildings with controlled access. It has an industrial elevator of 2 tons. It is suitable for any use.

Objektnummer: GR23373109 - 122 42 Athens Center – Central Greece

Ansprechpartner

Weitere Informationen erhalten Sie über Ihren Ansprechpartner:

VON POLL REAL ESTATE Athens

Kifisias Avenue 227 Athen
E-Mail: salesgreece@von-poll.com

To Disclaimer of von Poll Immobilien GmbH

www.von-poll.com