

Athens Center – Central Greece

# Commercial building of high visibility.

Objektnummer: GR23373109

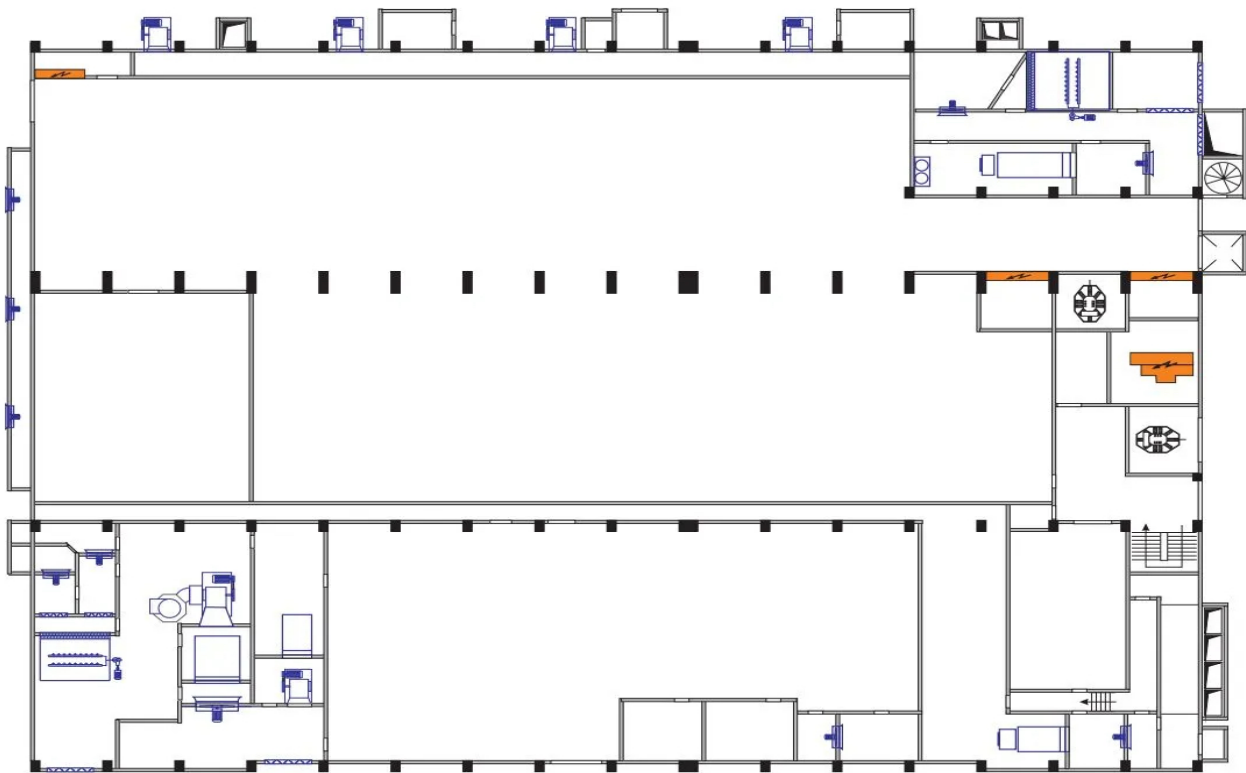

ΚΑΙΜΑ Ε : 1 : 200

MIETPREIS: 45.000 EUR

Objektnummer: GR23373109 - 122 42 Athens Center – Central Greece

- Auf einen Blick
- Die Immobilie
- Ein erster Eindruck
- Ansprechpartner

Objektnummer: GR23373109 - 122 42 Athens Center – Central Greece

## Auf einen Blick

Objektnummer	GR23373109	Büro/Praxen	Bürofläche
Bezugsfrei ab	nach Vereinbarung	Gesamtfläche	ca. 9.000 m <sup>2</sup>
Baujahr	1973	Nutzfläche	ca. 0 m <sup>2</sup>

Objektnummer: GR23373109 - 122 42 Athens Center – Central Greece

## Die Immobilie

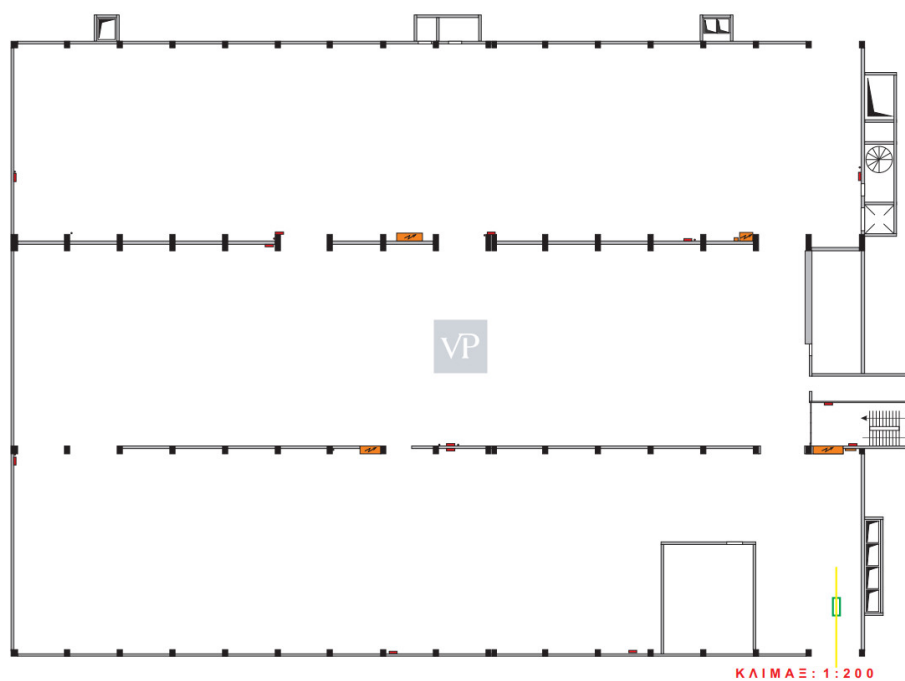
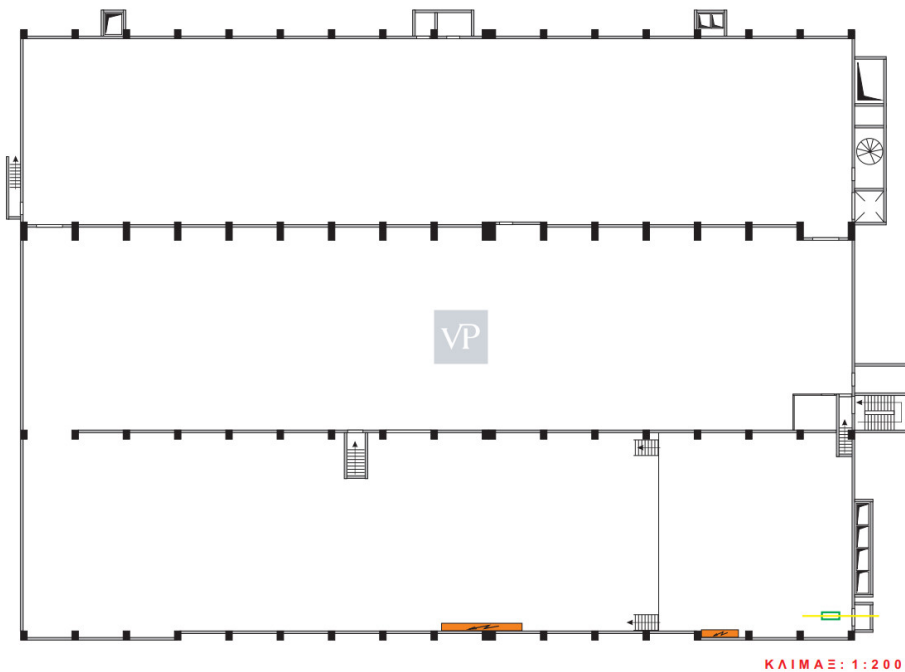

**Objektnummer: GR23373109 - 122 42 Athens Center – Central Greece**

## Ein erster Eindruck

Commercial Building of high visibility. Surface 9000m<sup>2</sup> Plot surface 5000m<sup>2</sup> Levels 3 It consists of 3 levels of 3000sqm (ground floor with 2.65m net height - 1st floor with 5m height - 2nd floor with 3.2m height). It has a yard area of 1800 sqm. It is located within a complex of commercial buildings with controlled access. WC 6 Number of entrances 2 Parking spots 50 Loading dock It has an industrial elevator of 2 tons. It is suitable for any use.

Objektnummer: GR23373109 - 122 42 Athens Center – Central Greece

## Ansprechpartner

Weitere Informationen erhalten Sie über Ihren Ansprechpartner:

VON POLL REAL ESTATE Athens

---

Kifisias Avenue 227 Athen  
E-Mail: [salesgreece@von-poll.com](mailto:salesgreece@von-poll.com)

*To Disclaimer of von Poll Immobilien GmbH*

---

[www.von-poll.com](http://www.von-poll.com)